

REHP HP Temperature Sensors

REPLACEMENT INSTRUCTIONS

Kit Name	HP Temperature Sensor (T3,T4,TP) - 50Gal	HP Temperature Sensor (T3,T4,TP) - 65 & 80Gal
Kit Part Number	105002066	105002067
Compatible Rinnai Products	REHP Series - 50 Gal Models	REHP Series - 65 & 80 Gal Models

WARNING Failure to correctly assemble the components according to these instructions may result in electric shock, injury, or death.

CAUTION

To protect yourself from harm, follow the steps below before proceeding.

- Antistatic gloves must be worn.
- Disconnect the electrical power supply by turning off the electricity at the circuit breaker.
- Turn off the water by closing manual ball valves for the hot and cold water connections at the appliance.

Items Inside Product Box

Before installation, please make sure all parts are located inside the product box.

Table 1

Item #	Item	Qty
1	HP Temperature Sensor (T3,T4,TP)	1

TOOLS/MATERIALS REQUIRED

- Phillips Head Screw Driver
- Flat Head Screw Driver
- Plastic Zip Ties

Figure 1

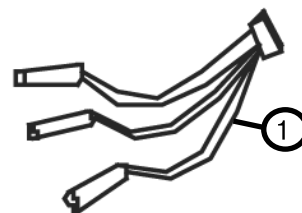

Instructions

1. Antistatic gloves must be worn to protect yourself from harm.
2. Disconnect the electrical power supply by turning off the electricity at the circuit breaker.
3. Turn off the water by closing manual valves for the hot and cold water connections at the appliance.
4. Use a Phillips head screw driver to remove 6 screws located around the appliance securing top cover to the appliance (Figure 2). Keep the removed 6 screws to be reinstalled in step 30.
5. Use a flat head screw driver to remove the display box front cover. To remove, slide the flat head of screw driver into the slots located on the bottom side of cover and twist the driver to remove (Figure 3). Keep front cover safe to be reinstalled in step 29.

IMPORTANT

When following the instructions to remove display box front cover, ensure not to apply unnecessary force. If applied, it may break the snap pins located on the display front cover and prevent it from assembling it back. Ensure to twist the screw driver softly and the cover should open without any damage.

Figure 2

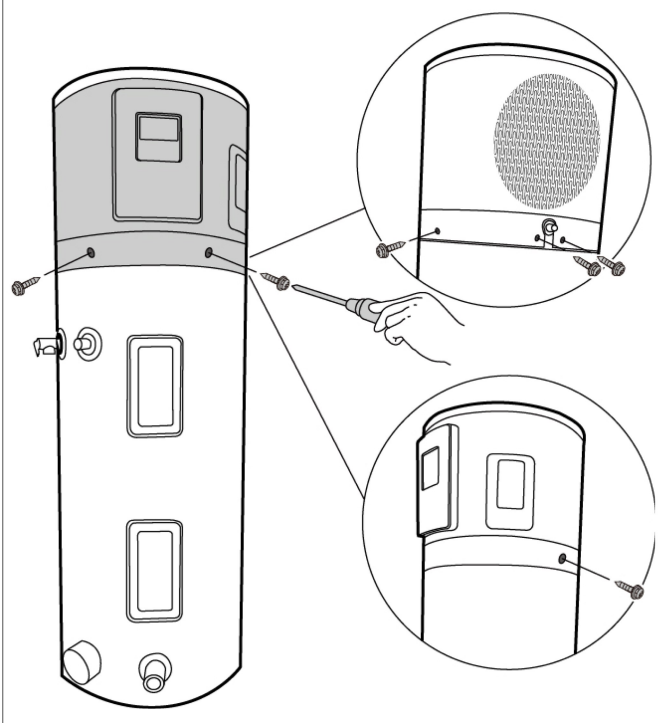
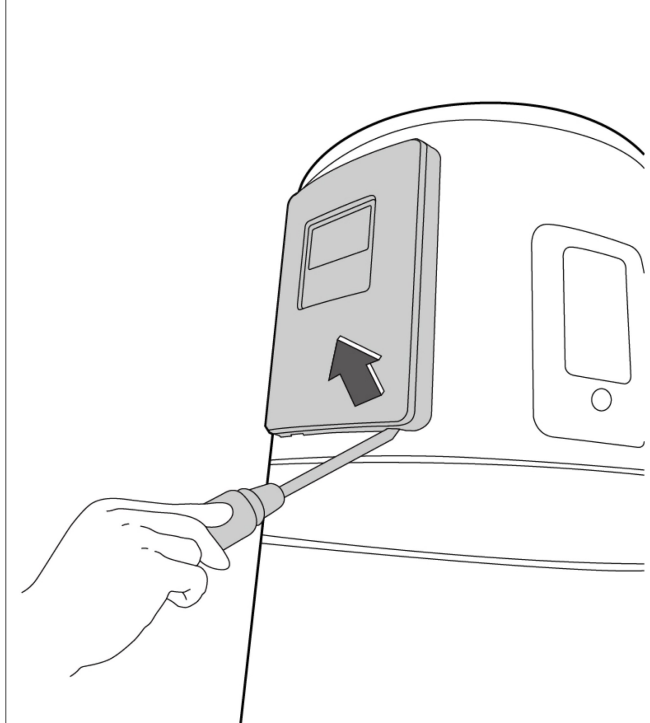

Figure 3



- 6. Use a Phillips head screw driver to remove 4 screws securing the display box rear cover (Figure 4). Keep removed 4 screws secured to be reinstalled in step 28.
- 7. Use a flat head screw driver to remove the display box. To remove, slide the flat head of screw driver into the slots located on the bottom side of box and twist the driver to remove (Figure 5).

IMPORTANT

When following the instructions to remove display box, ensure not to apply unnecessary force. If applied, it may break the snap pins located on the display box and prevent it from assembling it back. Ensure to twist the screw driver softly and the box should open without any damage.

Figure 4

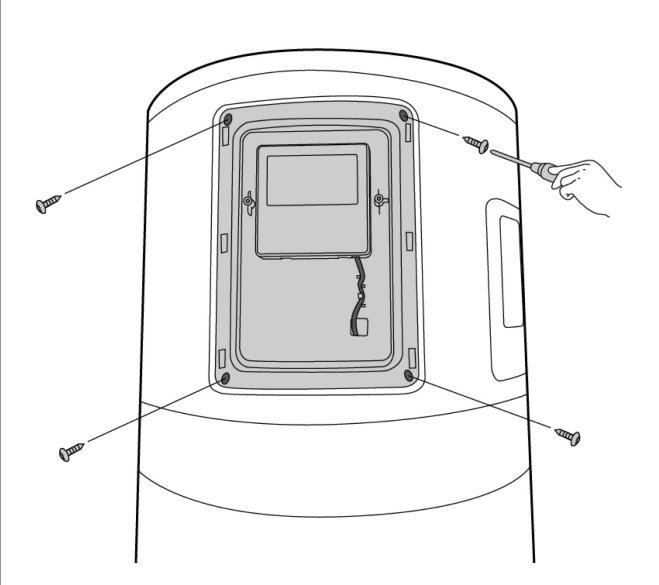
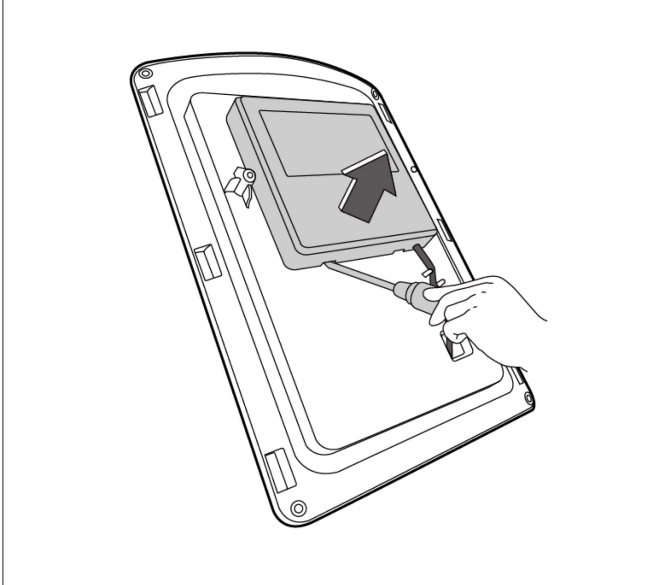

Figure 5



- 8. Disconnect the display board connector from the display board (Figure 6). Keep display box and display board safe to be reinstalled in step 26 & step 27.
- 9. Use a Phillips head screw driver to remove 4 screws securing the cover of main control E-box (Figure 7). The cover contains two items, the sheet metal piece supported with the plastic cover, ensure to remove both. Keep the cover safe to reinstalled in step 25.

Figure 6

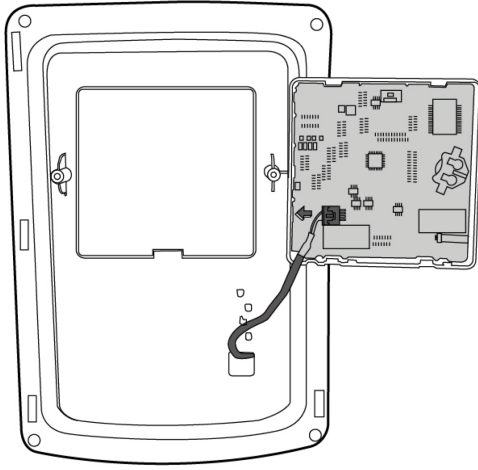
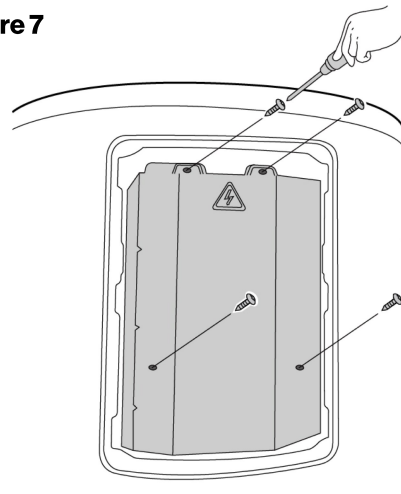

Figure 7



10. Disconnect HP temperature sensors cable from CN28 connector on the main control board (Figure 8). Ensure to remove retention clip before disconnecting the connector from the board.
11. Use a Phillips head screw driver to remove 6 screws securing the junction box cover and CTA 2045 cover (Figure 9). Keep these 6 screws safe to be reused in step 23.

Figure 8

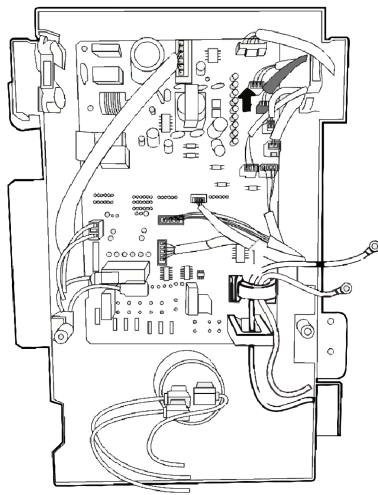
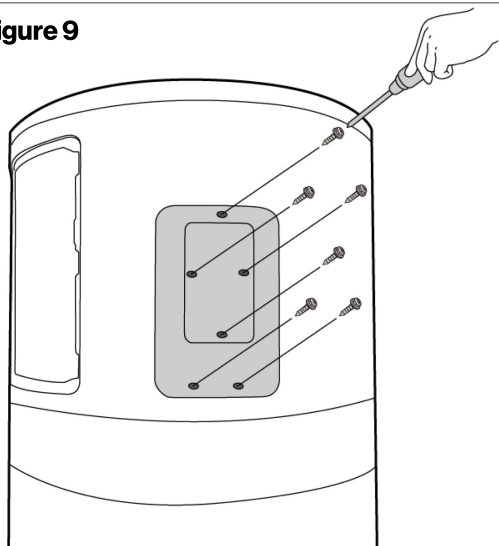

Figure 9



12. Use a Phillips head screw driver to remove 2 screws and release line L1 (black) and line L2 (white) (Figure 10). Disconnect power supply cable from the electrical breaker if needed. Keep removed 2 screws safe to be reinstalled in step 22.
13. Remove CTA2045 connector from the junction box cover (Figure 11). Keep junction box cover and CTA2045 cover secured to be reused in step 21.

Figure 10

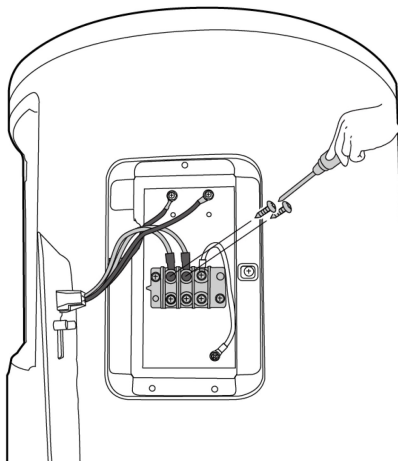
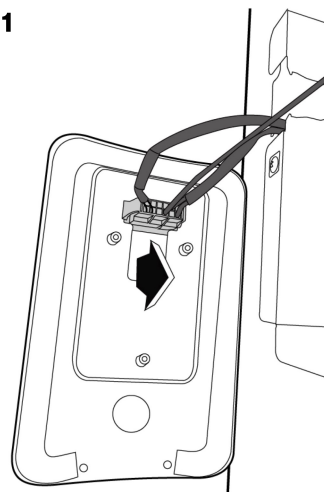
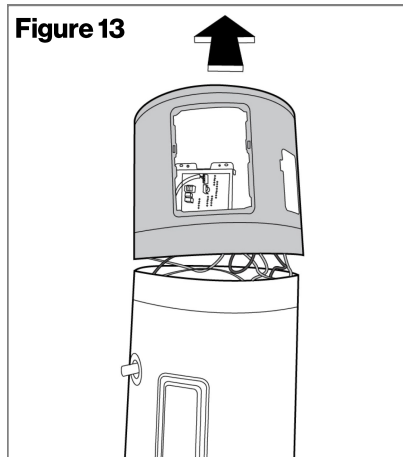
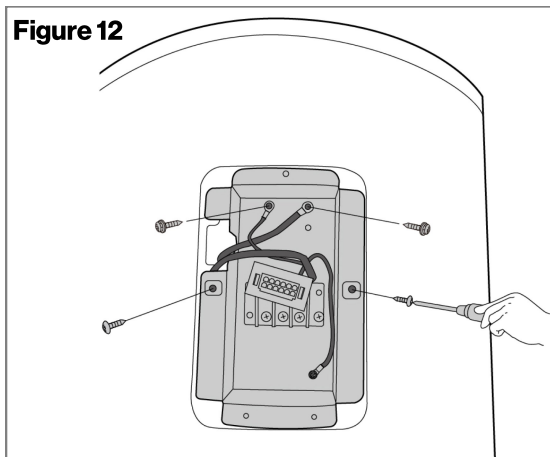

Figure 11



14. Use a Phillips head screw driver to remove 2 grounding screws and 2 screws securing junction box to the appliance (Figure 12). Keep the junction box safe to be reinstalled in step 20.
15. Carefully slide the top cover upwards to remove (Figure 13). Keep the top cover safe to be reinstalled in step 19.



16. Locate the T3, T4 and TP temperature sensors on the top side on appliance. Remove the insulation cover (sponge) around the sensors and remove clamps to take off T3 and TP sensors. Slide off, T4 sensor from the plastic clamp and cut zip ties to pull out the whole connector with sensors (Figure 14). Be cautious not to damage any other components on the appliance. Keep the insulation cover safe to be reinstalled in step 18.

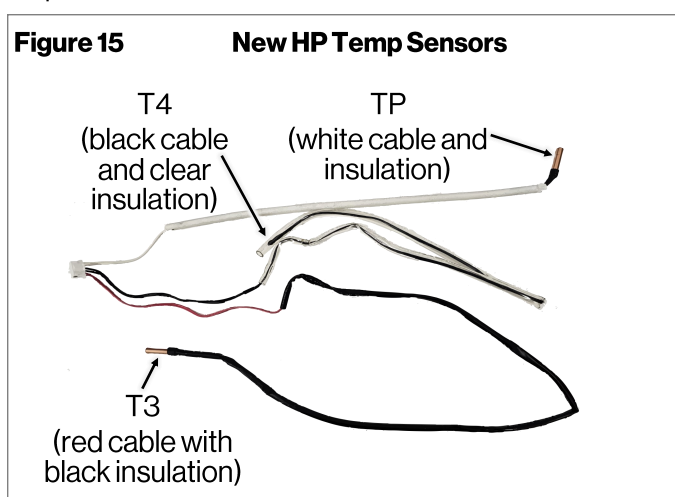
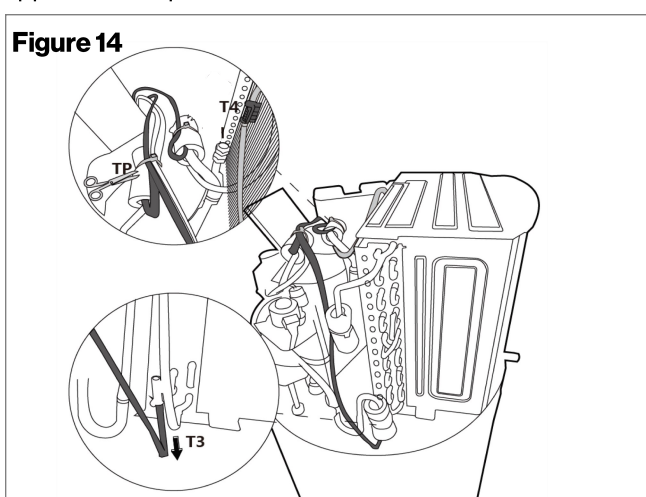

HP Temperature Sensors Reassembly

17. Identify sensors on the new HP temp sensors (Figure 15).
18. Install new HP temperature sensors (T3, T4 & TP) (Figure 14). Ensure to secure insulation cover (sponge) around sensors using zip ties.
19. Slide back the top cover on the appliance (Figure 13). Ensure to align the top cover to the appliance correctly so the cavity of the main control board on the top cover lines up with the main control board.
20. Reinstall grounding cables and junction box on the appliance using 4 screws (Figure 12).
21. Snap back the CTA-2045 connector on the junction box cover (Figure 11).
22. Mount back power supply cables, line L1 (black) and L2 (white) using 2 screws as shown in Figure 10.
23. Reinstall junction box cover and CTA 2045 cover using 6 screws (Figure 9).
24. Connect new HP temp sensors to CN28 on the main control board (Figure 8). Ensure to secure the connector using a retention pin.
25. Reinstall the cover to main control E-box using 4 screws (Figure 7).
26. Reconnect the display board connector (Figure 6).
27. Install back the display board on the display box rear cover (Figure 5).
28. Reinstall display box rear cover on the appliance using 4 screws (Figure 4).
29. Install back display box front cover on top of display box rear cover (Figure 3).
30. Secure top cover to the appliance using 6 screws (Figure 2).
31. Turn on the water by opening manual valves for the hot and cold water connections at the appliance.
32. Reconnect the electrical power supply by turning on the electricity at the circuit breaker.
33. Ensure that the appliance runs fine. May need to open one of the faucets in the house to fire up the appliance.